



J-8015
5 Gallon Buddy Pack
JCP Low Viscosity Lane Oil 100% Solids
Non-evaporating solvent. Fights dispersment caused by reactive balls. This lighter oil tracks ideally and wicks in most lane equipment, and remains cleaner than other solid products.



J-5015
5 Gallon Buddy Pack
JCP High Viscosity Lane Oil time tested solvent mix and lightweight conditioner with ideal wicking characteristics. Custom mix of cleaners makes for cleaner lanes. Slow evaporation makes this great for dry low humidity areas.



J-8505
5 Gallon Buddy Pack
JCP High Viscosity Lane Oil 100% Solids
Non-evaporating solvent. Fights dispersment caused by reactive balls. Less blending is required for the maximum flow of viscosity through the majority of most wick machines. This also remains cleaner than other solid products.



J-5115
5 Gallon Buddy Pack
JCP Low Viscosity Lane Oil time tested solvent mix and lightweight conditioner with ideal wicking characteristics. Custom mix of cleaners makes for cleaner lanes. Faster evaporation makes this great for high humidity areas.



J-75915
5 Gallon Buddy Pack
JCP Heavy Duty Lane Cleaner This water based heavy duty custom mix can be used in most lane cleaning machines or by hand. The J-75915 has great economic dilution ratio and can be used on all finishes and surfaces. The J-75915 is ideal for general bowling center cleaning.



J-75835
5 Gallon Buddy Pack
JCP Detergent Lane Cleaner water based non-filming detergent mix can be used in most lane cleaners, and on all surfaces. Economic dilution ratio.



JCP DUSTER CLOTH
294-008-460
61-860250-000
REPLACES DBA 8460



JCP DUSTER CLOTH
294-008-443
52-860078-000
REPLACES DBA 8443



JCP DUSTER CLOTH
294-008-430
61-860168-000
REPLACES DBA 8430

PIN FORK
15-8100

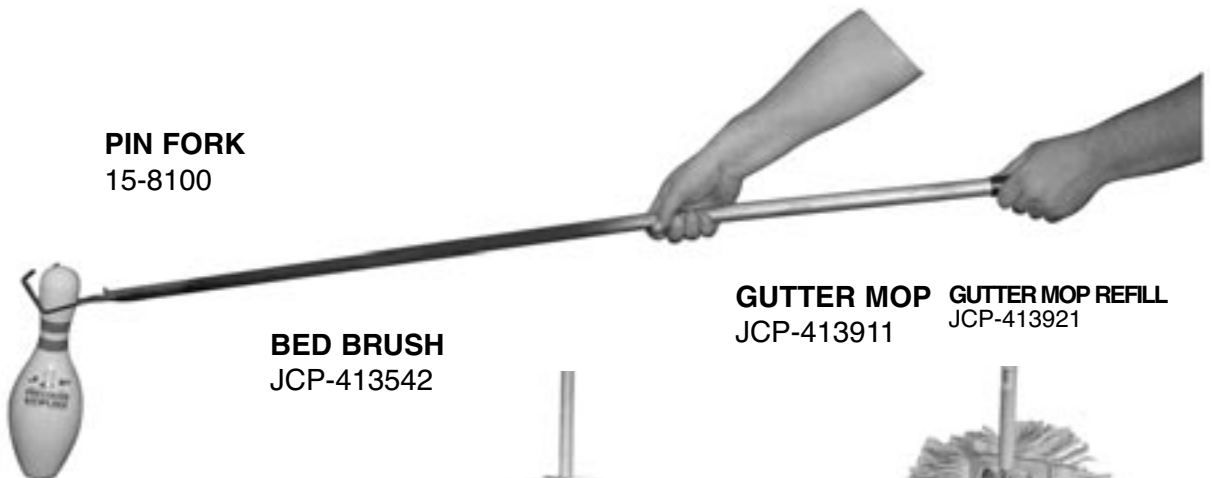

APPROACH MOP
JCP-435

APPROACH MOP REFILL
JCP-435R

BED BRUSH
JCP-413542

GUTTER MOP **GUTTER MOP REFILL**
JCP-413911 JCP-413921

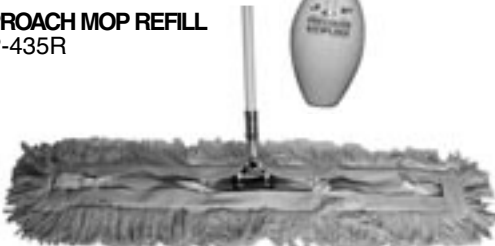

RENTAL SHOES ORDER FORM

154

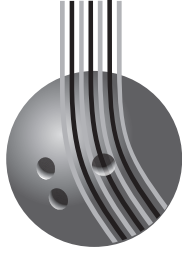

200 OVAL DRIVE ISLANDIA, NY 11749
 TEL 631 582 5450, 800 366 4JCP FAX 631 582 5875

SOLD TO: (SAME AS "SHIP TO" UNLESS OTHERWISE NOTED)

SOLD TO:
 CENTER NAME _____
 ADDRESS _____
 CITY _____ STATE _____ ZIP _____
 ORDERED BY _____
 PHONE NUMBER _____

SHIP TO:
 CENTER NAME _____
 ADDRESS _____
 CITY _____ STATE _____ ZIP _____
 ORDERED BY _____
 PHONE NUMBER _____









Style #	Description	5	5.5	6	6.5	7	7.5	8	8.5	9	9.5	10	10.5	11	11.5	12	13	14	15	16	17	18	19	20	Total Pair	JCP Price	Total Price	
90000	MENS COWHIDE LEATHER LACE																											
90010	WOMENS COWHIDE LEATHER LACE																											
70000	MENS SUEDE LACE																											
70010	WOMENS SUEDE LACE																											
		8	10	11	12	13	1	2	3	4	4.5	5	5.5	6	6.5	7	7.5	8	8.5	9	9.5	10	10.5	11				
60001	BOYS SUEDE VELCRO																											
60011	GIRLS SUEDE VELCRO																											

48 PAIRS OR MORE FREE FREIGHT

FREE FREIGHT CONTINENTAL U.S.

GLOW STITCHING SIZE

-  100% COWHIDE LEATHER OR SUEDE
-  GLOW STITCH SIZE
-  FULLY LEATHER LINED
-  DOUBLE REINFORCED EYELETS
-  FULLY CEMENTED & STITCHED RUBBER HEEL
-  EZEE SLIDE LEATHER SOLE
-  STEEL SHANK FOR SUPPORT

SHOE LACES

- 50140 RENTAL SHOE LACES BLACK 40" (72 PAIRS)
- 50036 RENTAL SHOE LACES WHITE 36" (72 PAIRS)
- 50240 YELLOW GLOW SHOE LACES 40" (72 PAIRS)
- 50236 YELLOW GLOW SHOE LACES 36" (72 PAIRS)

Grand Total

GEAR BOX SUB ASSEMBLIES EXCHANGE PROGRAM

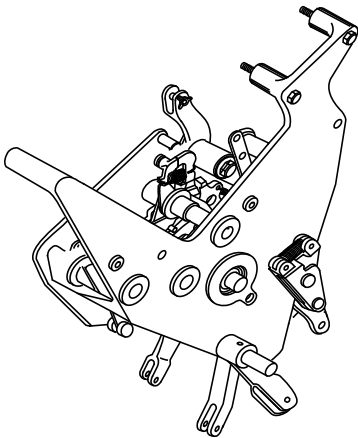

DETECTOR

12-860038-081 REBUILT DETECTOR, A
12-862038-081 REBUILT DETECTOR, A2

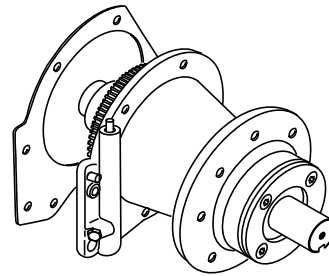

RAKE CRANK HOUSING (4:1)

MODEL A 12-860863-002 NEW
(60:1) 12-860863-081 REBUILT

MODEL A-2 12-862863-003 NEW
(60:1) 12-862863-081 REBUILT

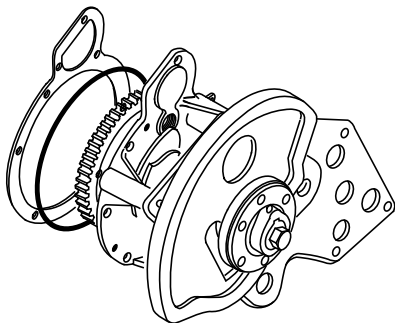

1 TO 1 GEAR BOX ASSY

MODEL A OR A-2 CONVERTED

12-860065-000 NEW

12-860065-081 REBUILT

MODEL A-2 (SCOTCH YOKE)

12-862065-000 NEW

12-862065-081 REBUILT

MODEL A-2 (LOWERING LINKS)

12-860065-000 NEW

12-860065-081 REBUILT

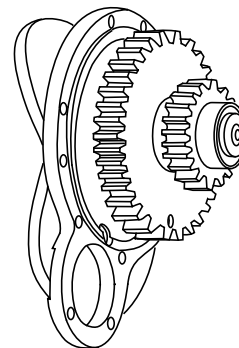

DECK LIFT CRANK (2:1)

MODEL A OR A-2 CONVERTED

12-860064-000 NEW

12-860064-081 REBUILT

MODEL A-2 (SCOTCH YOKE)

12-862074-000 NEW

12-862074-081 REBUILT

MODEL A-2 (LOWERING LINKS)

12-860064-000 NEW

12-860064-081 REBUILT